

DATA CAPTURE SPECIFICATIONS:

MSR	
Reference Standard	<ul style="list-style-type: none"><li>• ANSI/ISO Standards 7810,7811-1/6, 7813</li><li>• JIS X6301, X6302</li><li>• AAMVA</li></ul>
Recording Method	Two-frequency coherent phase (F2F)
Decoding Method	ISO Track1 - IATA , Track2 - ABA and Track3 – THRIFT
Card Swiping Direction	Bi-directional
Card Swiping Speed	Card speed through the unit may vary from 3 ips to 100 ips (7 cm/s to 250 cm/s)
Life	Electronics: 125,000 hours; Head: 1,000,000 passes
RFID	
Frequency	13.56MHz ±7KHz
Modulate Mode	FSK
Reading Range	within 30mm depending on type of tags
HF RFID Reader	ISO 15693, 14443A, 14443B, Felica UID

\* Specifications subject to change without notice.



Handheld POS Terminals

WebDT 410

BASIC OPERATION GUIDE

ENGLISH



INTRODUCTION

Thank you for acquiring the WebDT 410, part of the POS Handheld line. The WebDT 410 offers a 3.5 outdoor-viewable touch screen, in a compact and lightweight package. The WebDT 410 enables efficient point-of-service applications, inventory management, and field services. With IP54 sealed front panel, the WebDT410 performs well inside and outside.

The WebDT Point-of-Service Handheld provides the precise features needed to streamline operations and improve productivity, data accuracy, and service.

PACKAGE CONTENTS

- 1. One WebDT 410
- 2. Basic operation guide
- 3. Stylus lanyard and hand strap

\* The actual package contents may vary depending on the configuration acquired.

PRECAUTIONS

- Always exercise care when operating and handling the WebDT 410.
- Do not disassemble any portion of the WebDT 410. It will void any product warranty on WebDT 410.
- Do not use any power adapter or charging cradle other than the one provided with the device or acquired from the manufacturer or its partners.
- In the unlikely event that abnormal noise, strange odor, or smoke is present, immediately power down the WebDT 410 and disconnect all power sources. Please report the problem to your device provider immediately.



DT Research, Inc.  
2000 Concourse Drive, San Jose, CA 95131 <http://www.dtresearch.com>  
Copyright © 2011, DT Research, Inc.  
All Rights Reserved. DT Research, WebDT are registered trademarks of DT Research, Inc.  
BOG011911DT410ENG

WebDT 410 Outlook

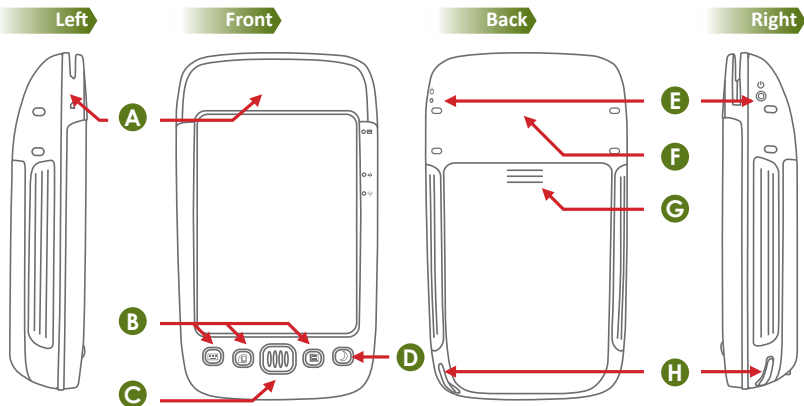

Bottom

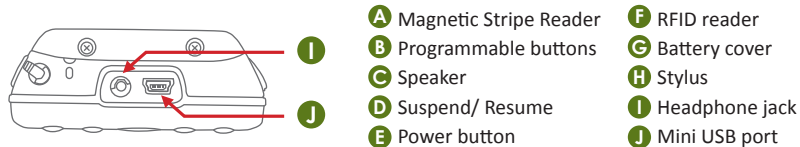

- A** Magnetic Stripe Reader
- B** Programmable buttons
- C** Speaker
- D** Suspend/ Resume
- E** Power button
- F** RFID reader
- G** Battery cover
- H** Stylus
- I** Headphone jack
- J** Mini USB port

Button Functions

- : Enable/ disable soft keyboard (Programmable)
- : Programmable
- : System Utility
- : Suspend/ Resume
- Hold + Press : Touch screen calibration

WebDT 410 LED Status Indicators

1. Magnetic Stripe Reader Indicator:

- Power On – Powering on Sequence: blinks orange 2 times, then lights solid blue
- Ready – Solid blue
- Read Ok – Blinks blue 1 time
- Read Error – Orange and then turn to blue

2. Power Mode Status Indicator:

- Blue: Device is powered on
- Blinking Blue: Main battery charging
- Orange: Low battery mode
- Blinking Orange: Extremely low battery mode
- Off: Device is powered off or in suspend mode

3. Wi-Fi Status Indicator:

- Blue: The device has been connected to a wireless AP
- Blinking blue: The device is connecting to a wireless AP
- Off: Wi-Fi is disabled



ACCESSORIES:



4-bay Gang Charger PN: ACC-410-02

Table and wall mountable charger, capable of charging up to 4 handhelds simultaneously.

SPECIFICATIONS

System	
Processor	ARM 533 MHz
Memory (RAM)	128MB DDR II, 128MB Flash ROM
Operating System	Microsoft® Windows® CE 6.0 or Windows® Mobile 6
Display	3.5" TFT-LCD with resistive touch; outdoor-viewable display
Display Resolution	240 x 320 (QVGA)/ 480 x 640 (VGA)
Network Interface	Built-in IEEE 802.11b/g WLAN and Bluetooth 2.0
Control Switch and Buttons	1 power button; 4 front buttons
Indicator	1 power-on LED indicator, 1 WLAN enable/ communication indicator, 1 MSR indicator
Speaker	Built-in speaker
Input/Output Ports	1 mini USB (for charging and ActiveSync only), 1 2.5mm stereo headset and microphone jack
Power	
AC/DC Adapter	Input: 100 – 240V AC; Output: 5V DC, 2A
Battery Type	Li-ion battery 3800 mAh, 3.7V
Mechanical	
Enclosure	PC+ABS, TPR
Stylus	Non-electronic tip
Dimensions (H x W x D)	5.5 x 3.1 x 1.2 in/ 140 x 81.8 x 31 mm
Weight	0.6 lbs/ 280 g
Environmental	
Regulatory	FCC Class B, CE, C-Tick, RoHS compliant
Water and Dust Resistance	Front Panel: IP54
Temperature	Operation: 0°C - 40°C; Storage: -20°C - 60°C
Humidity	0% - 90% non-condensing

\* Specifications subject to change without notice.